



# KOA PREMIER

KOA SERIES – THE 60S  
RESIDENCE 60.20

*Ka Makana*  
AT HOAKALEI



RESIDENCE 60.20 A (R)



RESIDENCE 60.20 B (MODEL)

4 bedrooms  
3.5 bathrooms

LIVING AREA . . . . .	3,288 SQ. FT.
COVERED LANAI . . . . .	246 SQ. FT.
COVERED BALCONY . . . . .	220 SQ. FT.
2-CAR GARAGE PLUS TANDEM . . . . .	604 SQ. FT.
TOTAL AREA . . . . .	4,358 SQ. FT.

SQUARE FOOTAGE REPRESENTS  
RESIDENCE 60.20 EXTERIOR B



4 bedrooms  
3.5 bathrooms

# KOA PREMIER

KOA SERIES – THE 60s  
RESIDENCE 60.20

LIVING AREA . . . . . 3,288 SQ. FT.  
COVERED LANAI . . . . . 246 SQ. FT.  
COVERED BALCONY . . . . . 220 SQ. FT.  
2-CAR GARAGE PLUS TANDEM . . . 604 SQ. FT.  
TOTAL AREA . . . . . 4,358 SQ. FT.

FLOORPLAN DEPICTS RESIDENCE 60.20 EXTERIOR B

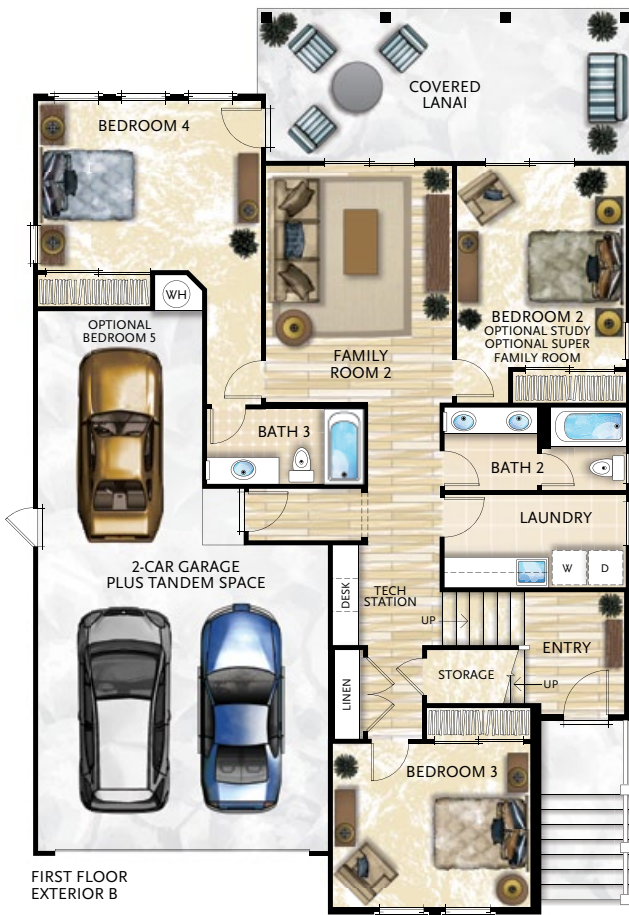

*Ka Makana*  
AT HOAKALEI

Illustrations are artists' conceptual depictions only of proposed improvements, are not necessarily to scale, and may differ from actual improvements, if any, when constructed. All square footage numbers are approximate and may vary due to plotting and field variations or method of measurement. We reserve the right to modify maps, floorplans, square footages, exteriors, specifications, features, dimensions, designs, building materials, options, colors, finishes, landscaping layout and materials, and product types without notice or obligation. Building configurations, garage locations, garage access doors and accompanying stoop, number of steps, and window sizes and configurations may vary from those shown in the illustrative example based upon the floorplan, homesite, elevation and options selected. Garden walls (depicted on drawings as dashed lines) may be included with a home at our sole discretion. Furniture layout size and placement are shown for conceptual purposes only, and therefore, purchasers should measure their own furniture to ensure that it fits in the desired locations. Furniture is not included in the purchase of a residence. The prices of our homes, standard features, and upgrades are subject to change at any time without prior notice or obligation and are subject to availability.

